



LP Gas Conversion Kit

Model: A00AA0912

If you have questions or need assistance during assembly, please call 1-888-94-SABER
1-888-947-2237

For support and to register your grill, please visit us at
www.sabergills.com



Tools required for assembly:

- Orifice Driving Tool - Provided
- (2) Adjustable Wrenches - Not Provided
- Standard #2 Phillips Screwdriver - Not Provided
- Flat Blade Screwdriver - Not Provided

To Installer/Assembler: Leave this manual with consumer.
To Consumer: Keep this manual for future reference.

PARTS LIST

Note: Illustrations are not to scale.

Key	Qty.	Description	Part No.
A	4	Main Burner Control Knob	80019936
B	1	Orifice Driving Tool	3499941
C	1	LP Cylinder Retention Bracket	3498833
D	4	LP Main Burner Orifice, # 66	80020312
E	1	Hose & Regulator	80020270
F	1	½" FIP x 3/8" Flare Fitting	80020397

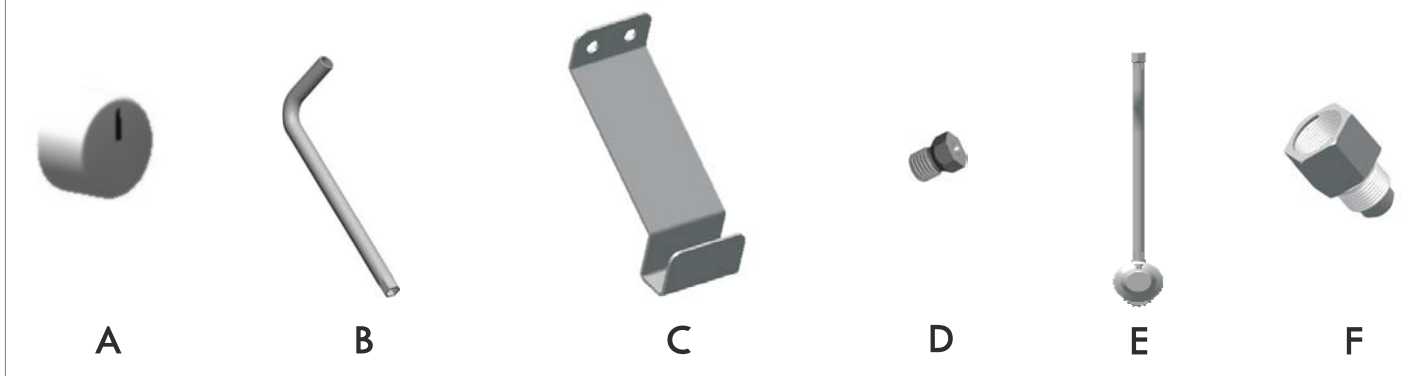

SAFETY SYMBOLS

The symbols and boxes shown below explain what each heading means. Read and follow all of the messages found throughout the manual.



DANGER: Indicates an imminently hazardous situation which, if not avoided, will result in death or serious injury.



WARNING: Indicates a potentially hazardous situation which, if not avoided, could result in death or serious injury.



CAUTION: Indicates a potentially hazardous situation or unsafe practice which, if not avoided, may result in minor or moderate injury.



If you smell gas:

- Shut off gas to appliance.
- Extinguish any open flame.
- Open lid.
- If odor continues, keep away from the appliance and immediately call your gas supplier or your fire department.



1. Do not store or use gasoline or other flammable liquids or vapors in the vicinity of this or any other appliance.
2. An LP tank not connected for use shall not be stored in the vicinity of this or any other appliance.



Do not attempt to repair or alter this conversion kit for any assumed defect. Any modification to this assembly will void your warranty and create the risk of a gas leak and fire. Use only authorized replacement parts supplied by manufacturer.



CALIFORNIA PROPOSITION 65
1. Combustion by-products produced when using this product contain chemicals known to the State of California to cause cancer, birth defects, and other reproductive harm.
2. This product contains chemicals, including lead and lead compounds, known to the State of California to cause cancer, birth defects or other reproductive harm. *Wash your hands after handling this product.*



1. Read and follow all Safety, Assembly and Use and Care Instructions in this guide before assembling and cooking with this grill.
2. Failure to follow all instructions in this Use and Care Guide may lead to fire or explosion, which could result in property damage, personal injury or death.



1. Some parts may contain sharp edges, especially as noted in these instructions.
2. Wear protective gloves if necessary.
3. For residential use only. Do not use for commercial cooking.



- Outdoor gas appliance is not intended to be installed in or on a boat.
- Outdoor gas appliance is not intended to be installed in or on an RV.
- Never attempt to attach this grill to the self-contained LP gas system of a camper trailer or motor home.
- Do not use grill until leak tested.
- If a leak is detected at any time, **STOP** and call the fire department.
- If you cannot stop a gas leak, **immediately** close LP cylinder valve and call LP supplier or your fire department!

USE AND CARE



***NEVER** store a spare cylinder under or near the appliance or in an enclosed area.

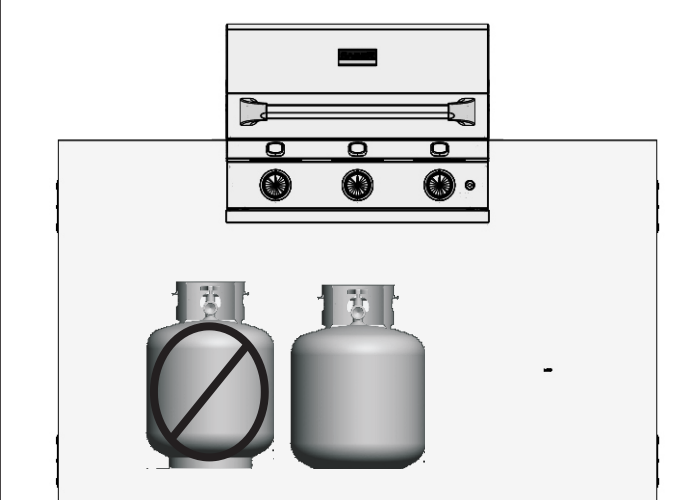

*Never fill a cylinder beyond 80% full.

*An over filled or improperly stored cylinder is a hazard due to possible gas release from the safety relief valve.

*If you see, smell or hear gas escaping, immediately get away from the LP cylinder/appliance and call your fire department.

*This could cause an intense fire with risk of property damage, serious injury or death.

LP Cylinder Removal, Transport and Storage

- Turn **OFF** all control knobs and LP cylinder valve. Turn regulator coupling nut counterclockwise by hand only - do not use tools to disconnect. Loosen cylinder screw beneath bottom shelf, then lift LP cylinder up and out of cart. Install safety cap onto LP cylinder valve. Always use cap and strap supplied with valve. **Failure to use safety cap as directed may result in serious personal injury and/or property damage.**
- A disconnected LP cylinder in LP Cylinder Valve storage or being transported must have a safety cap installed (as shown). Do not store an LP cylinder in enclosed spaces such as a carport, garage, porch, covered patio or other building. Never leave an LP cylinder inside a vehicle which may become overheated Retainer Strap by the sun.
- Do not store an LP cylinder in an area where children play.



LP Cylinder Exchange

- Many retailers that sell grills offer you the option of replacing your empty LP cylinder through an exchange service. Use only those reputable exchange companies that inspect, precision fill, test and certify their cylinders. **Exchange your cylinder only for an OPD safety feature-equipped cylinder as described in the "LP Cylinder" section of this manual.**
- Always keep new and exchanged LP cylinders in upright position during use, transit or storage.
- **Leak test new and exchanged LP cylinders BEFORE connecting to grill.**

LP Cylinder Leak Test

- For your safety**
- Leak test must be repeated each time LP cylinder is exchanged or refilled.
 - Do not smoke during leak test.
 - Do not use an open flame to check for gas leaks.
 - Grill must be leak tested outdoors in a well-ventilated area, away from ignition sources such as gas fired or electrical appliances. During leak test, keep grill away from open flames or sparks.
 - Use a clean paintbrush and a 50/50 mild soap and water solution. Brush soapy solution onto areas indicated by arrows in figure below.
 - **Do not use household cleaning agents.** Damage to gas train components can result.

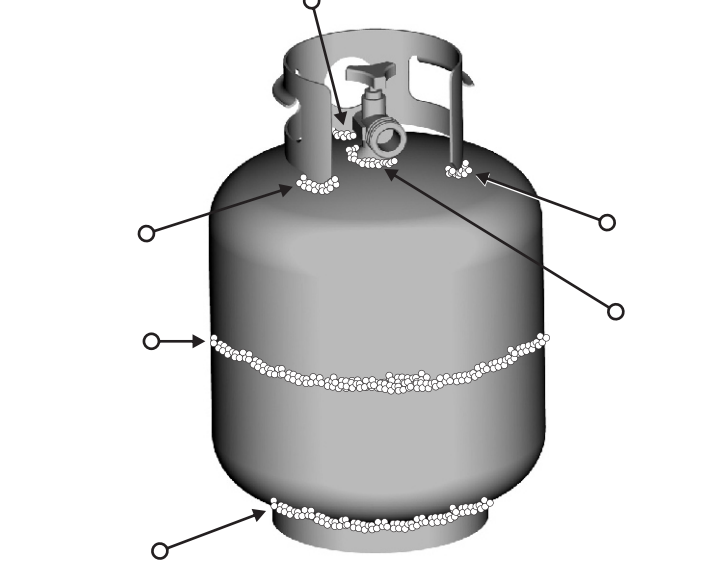

If "growing" bubbles appear do not use or move the LP cylinder. Contact an LP gas supplier or your fire department!



- The LP cylinder used with your grill must meet the following requirements:**
- Use LP cylinders only with these required measurements: 12" (30.5cm) (diameter) x 18" (45.7cm) (tall) with 20 lb. (9kg) capacity maximum.
 - LP cylinders must be constructed and marked in accordance with specifications for LP cylinders of the U. S. Department of Transportation (DOT) or for Canada, CAN/CSA-B339, cylinders, spheres and tubes for transportation of dangerous goods. Transport Canada (TC). See cylinder collar for marking.
 - LP cylinder valve must have:
 - Type 1 outlet compatible with regulator or grill.
 - Safety relief valve.
 - UL listed Overfill Protection Device (OPD). This OPD safety feature is identified by a unique triangular hand wheel.**Use only LP cylinders equipped with this type of valve.**
 - LP cylinder must be arranged for vapor withdrawal and include collar to protect LP cylinder valve. Always keep LP cylinder in upright position during use, transit or storage.



Do not insert any tool or foreign object into the valve outlet or safety relief valve. You may damage the valve and cause a leak. Leaking propane may result in explosion, fire, severe personal injury, or death.

Safety Tips

- Before opening LP cylinder valve, check the regulator coupling nut for tightness.
- When grill is not in use, turn **OFF** all control knobs and LP cylinder valve.
- Use long handled barbecue utensils and oven mitts to avoid burns and splatters.
- The grease tray **must** be inserted into grill and emptied after each use. Do not remove grease tray until grill has completely cooled.
- Clean grill often, preferably after each cookout. If a bristle brush is used to clean any of the grill cooking surfaces, ensure no loose bristles remain on cooking surfaces prior to grilling. It is not recommended to clean cooking surfaces while grill is hot.
- If you notice grease or other hot material dripping from grill onto valve, hose or regulator, turn off gas supply at once. Determine the cause, correct it, then clean and inspect valve, hose and regulator before continuing. Perform a leak test.
- Keep ventilation openings in cylinder and grill enclosure free and clear of debris.
- Do not store objects or materials inside the grill enclosure that would block the flow of combustion air to the underside of either the control panel or the firebox.
- The regulator may make a humming or whistling noise during operation. This will not affect safety or use of grill.
- If you have a grill problem see the "Troubleshooting Section" of the Grill Product Guide.
- If the regulator frosts, turn **OFF** grill and LP cylinder valve immediately. This indicates a problem with the cylinder and it should not be used on any product. **Return to supplier!**



LP cylinder in upright position for vapor withdrawal

LP (Liquefied Petroleum Gas)

- LP gas is nontoxic, odorless and colorless when produced. **For Your Safety,** LP gas has been given an odor (similar to rotten cabbage) so that it can be smelled.
- LP gas is highly flammable and may ignite unexpectedly when mixed with air.

LP Cylinder Filling

- Use only licensed and experienced dealers.
- LP dealer **must purge new cylinder** before filling.
- Dealer should **NEVER** fill LP cylinder more than 80% of LP cylinder volume. Volume of propane in cylinder will vary by temperature.
- A frosty regulator indicates gas overfill. Immediately close LP cylinder valve and call local LP gas dealer for assistance.
- Do not release liquid propane (LP) gas into the atmosphere. This is a hazardous practice.
- To remove gas from LP cylinder, contact an LP dealer or call a local fire department for assistance. Check the telephone directory under "Gas Companies" for nearest certified LP dealers.



For Safe Use of Your Grill and to avoid serious injury:

- Do not let children operate or play near grill.
- Keep grill area clear and free from materials that burn.
- Do not block holes in sides or back of grill.
- Check burner flames regularly.
- Use grill only in well-ventilated space. **NEVER** use in enclosed space such as carport, garage, porch, covered patio, or under an overhead structure of any kind.
- Do not use charcoal or ceramic briquets in a gas grill.
- **Use grill at least 3 ft. from any wall or surface.** Maintain 10 ft. clearance to objects that can catch fire or sources of ignition such as pilot lights on water heaters, live electrical appliances, etc.

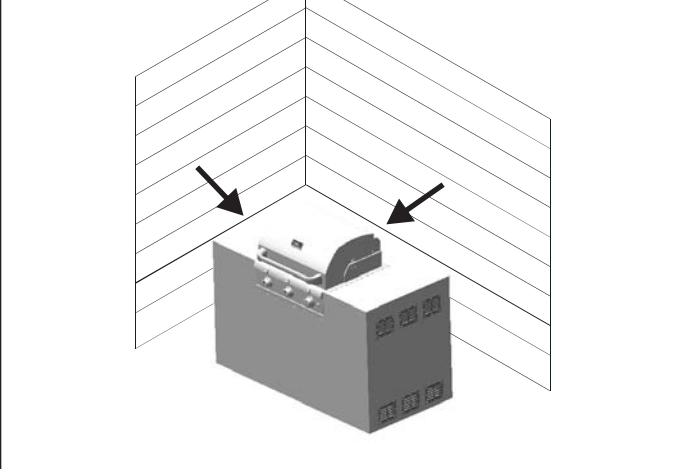

For Safe Use of Your Grill and to avoid serious injury:

- Apartment Dwellers:**
- Check with management to learn the requirements and fire codes for using an LP gas grill in your apartment complex. If allowed, use outside on the ground floor with a three (3) foot clearance from walls or rails. Do not use on or under balconies.
 - **NEVER** attempt to light burner with lid closed. A build-up of non-ignited gas inside a closed grill is hazardous.
 - Never operate grill with LP cylinder out of correct position specified in assembly instructions.
 - Always close LP cylinder valve and remove regulator coupling nut before moving LP cylinder from specified operation position.

ADDITIONAL ENCLOSURE CONSTRUCTION

For a LP cylinder enclosure having four sides, a top and a bottom:

1. At least one ventilation opening shall be provided on the exposed exterior side or rear of the enclosure located within 5 inches of the top of the enclosure and unobstructed. The opening(s) shall have a total area of not less than 1 in²/lb of stored fuel capacity (example 20lb cylinder = 20 in²).
2. At least one ventilation opening shall be provided on the exposed, exterior side or rear of the enclosure 1 inch or less from the floor level and shall have a total free area of not less than ½ in²/lb of stored fuel capacity (example : 20lb. cylinder = 10 in²).
3. Every opening shall have a minimum dimension so as to permit the entrance of a 1/8 inch rod.
4. A 2 inch air gap **MUST** be provided between the bottom of the enclosure and the ground.
5. A door or opening **MUST** be provided on the enclosure that will allow easy access to the remote LP cylinder. The cylinder valve on the LP cylinder **MUST** be readily accessible for hand operation. The LP cylinder **MUST** be positioned to allow leak checking of the cylinder, cylinder valve, and regulator as they are attached to the grill.
6. An LP cylinder retention bracket (provided with this kit) must be installed in the enclosure (see step 9, LP Cylinder Retention Bracket Installation).

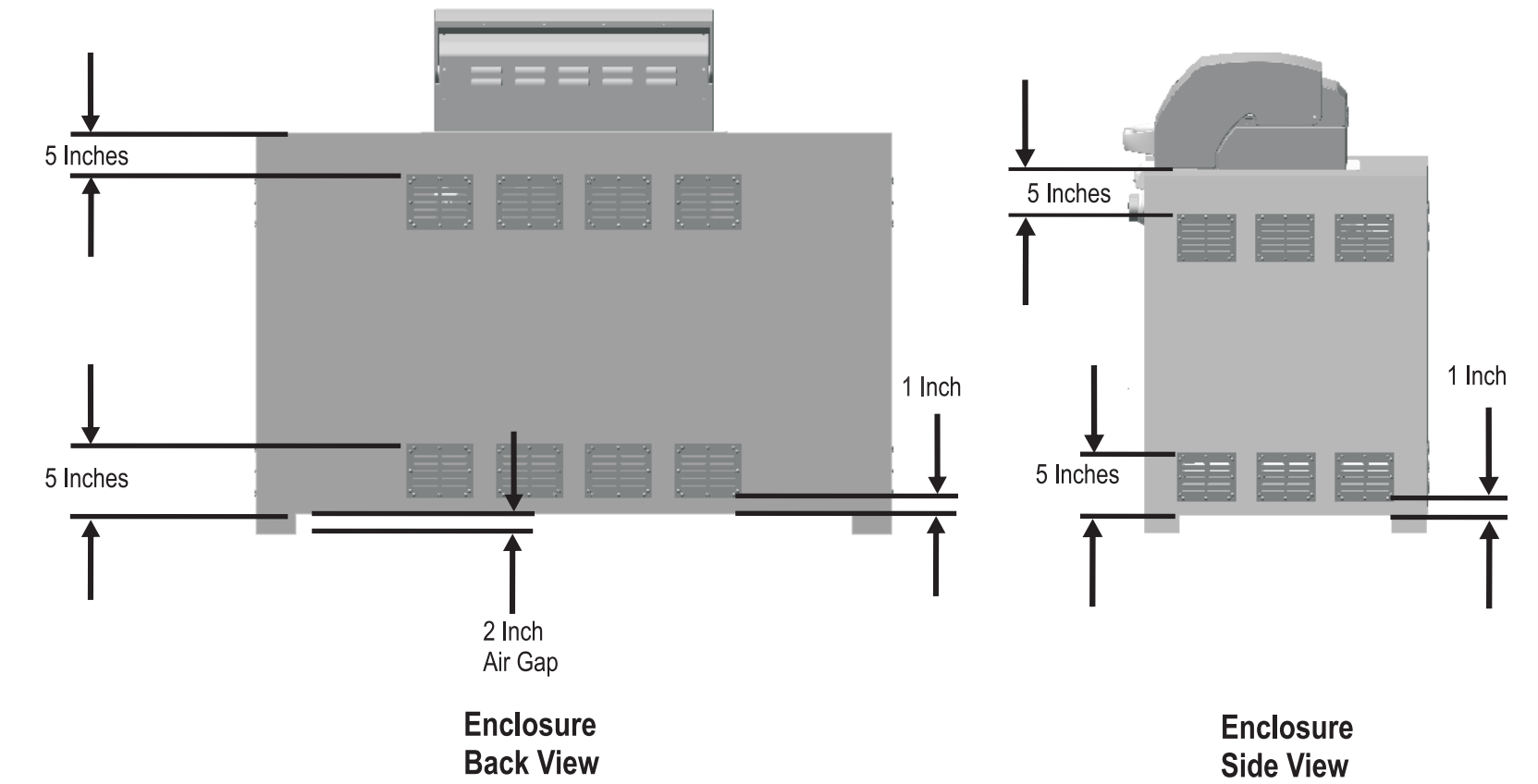

MAIN BURNER CONVERSION

Step 1

Next, make sure all control knobs are in the **OFF** position, gas supply is disconnected and removed from grill.
Next, open lid and remove warming rack, cooking grates and emitters.
Remove the grease tray.

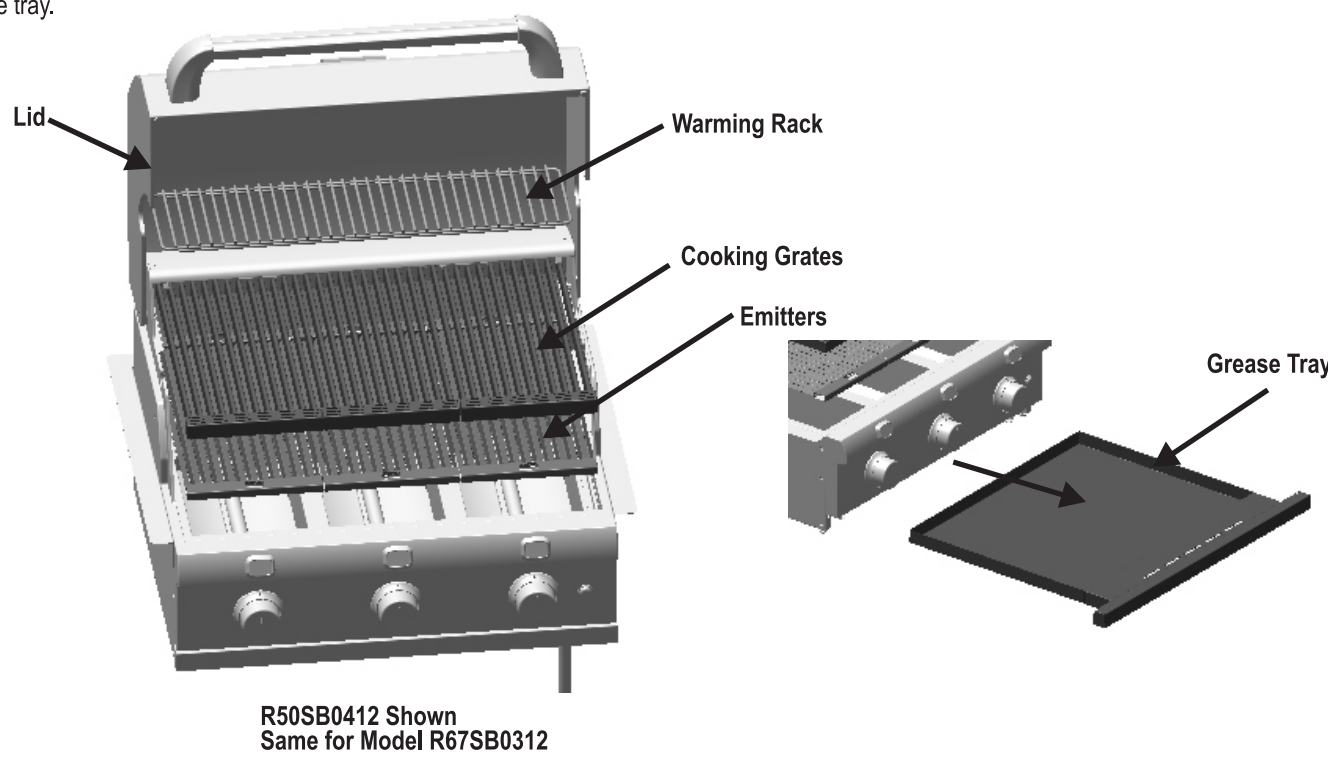

Step 2

Remove retaining clip and remove carryover tubes.
Remove retaining clips at back of burners to detach burners from firebox burner brackets.
Using a flat blade screwdriver pry off the electrode from each burner. Electrode should remain in burner box.
Lift back of burner while sliding burner out of firebox, disengaging burners from valves.

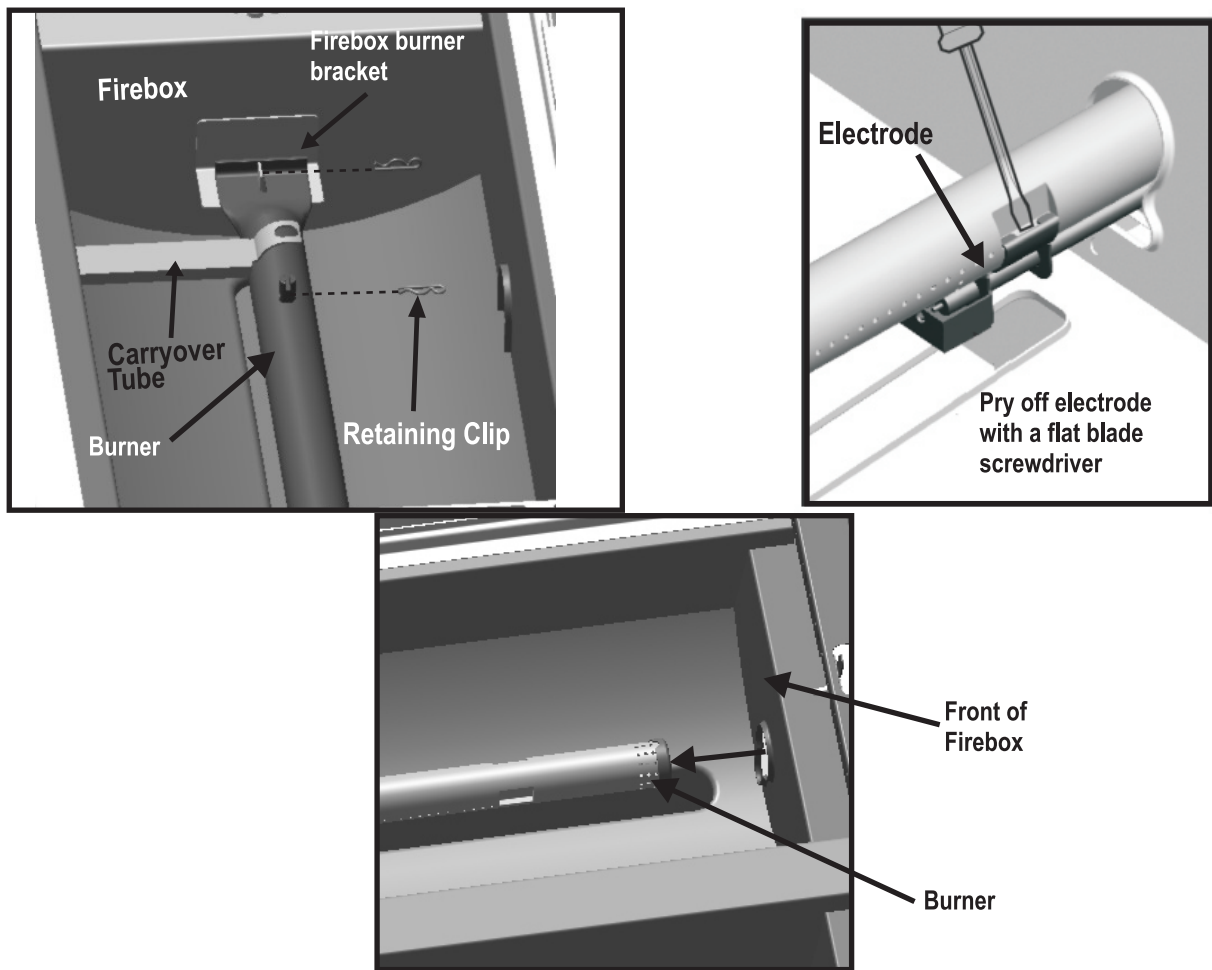

Step 3

Insert orifice driving tool into firebox burner openings and screw (clockwise) orifices into ends of valves. Secure tightly.

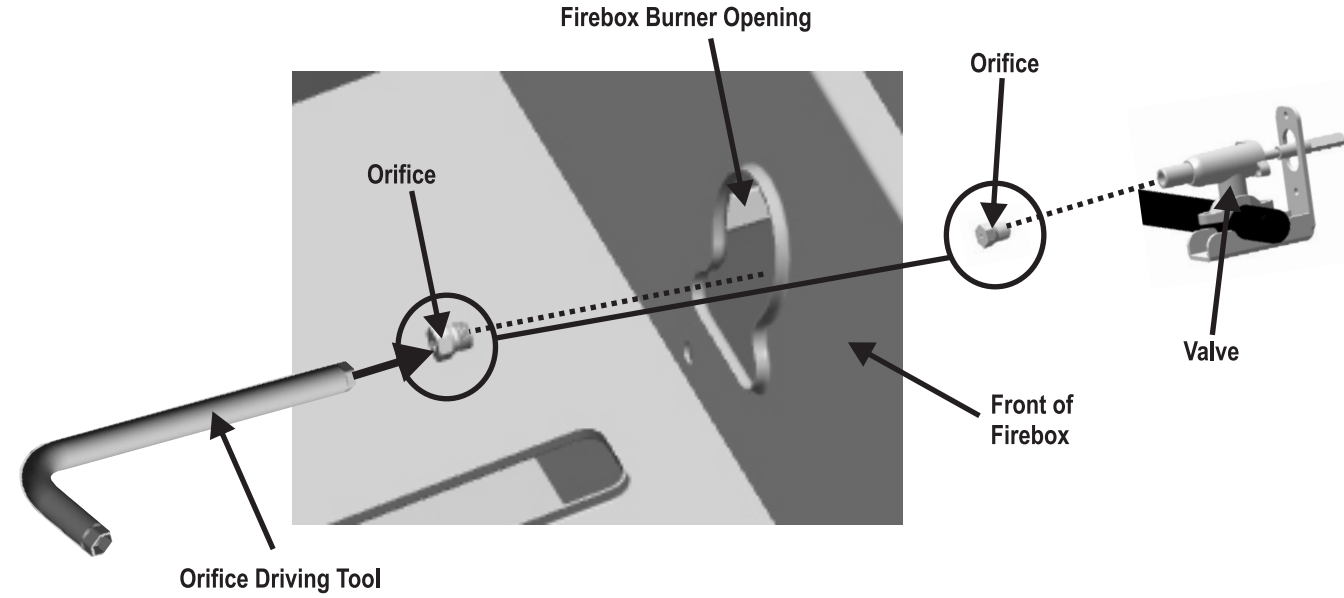

Step 4

Replace electrodes on to tube burners. Reference illustration Step 2.

Insert tube burners into firebox burner holes over valves with ignitor assembly downward, making sure tube burner engages valve properly. See diagram below.

Secure tube burners to burner brackets with previously removed retaining clips. Replace carryover tubes and secure with retaining clips previously removed. Reference illustration Step 2.

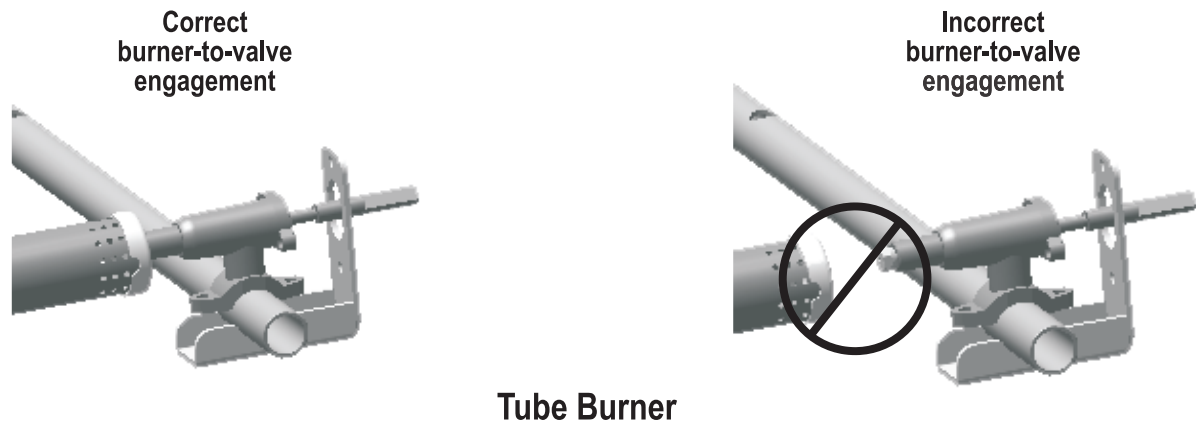

Step 5

Pull the NG main burner control knob off of valve stem.

Press LP gas control knob, provided with this kit, back onto valve stem. NOTE: LP is located inside of the LP gas control knob as shown.

Repeat for each control knob.

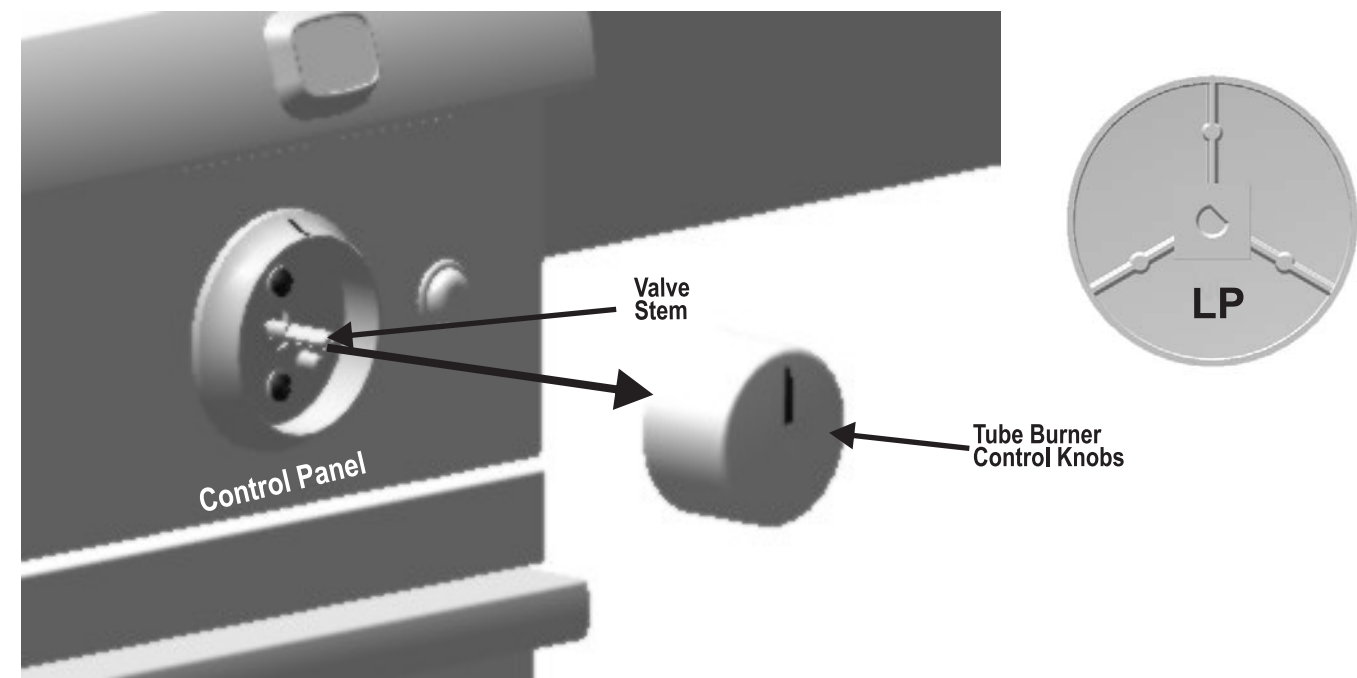

Step 6

Reinstall emitters, cooking grates and warming rack, reference Step 1 for reinstallation.

LP GAS HOSE CONVERSION

Step 7

NOTE: If you are installing your Saber® built-in grill for the first time, the natural gas (NG) regulator will not be connected to the grill. Proceed to Step 8.

Using (1) wrench (not provided), unscrew (counterclockwise) and remove the NG regulator, taking care not to damage the 1/2" pipe.

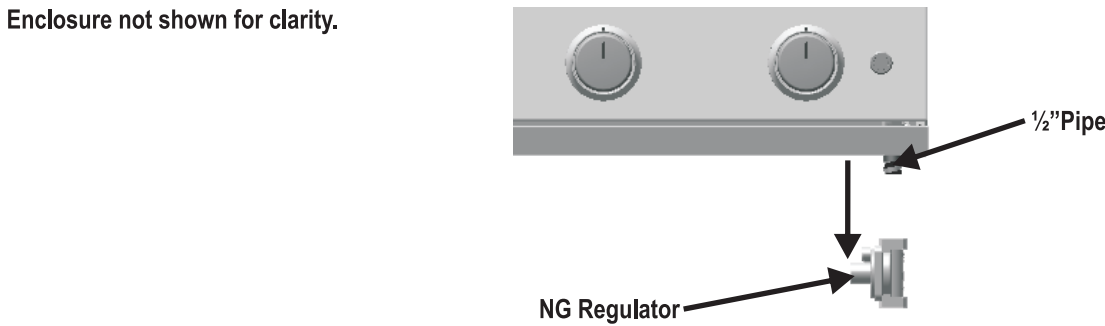

Step 8

Apply pipe joint compound (not provided) to the 1/2" pipe.

Using (1) wrench (not provided) screw (clockwise) the 1/2" FIP x 3/8" flare fitting onto the 1/2" pipe and tighten securely.

Using (2) wrenches (not provided) screw (clockwise) the LP gas hose and regulator assembly onto the 3/8" flare fitting and tighten securely.

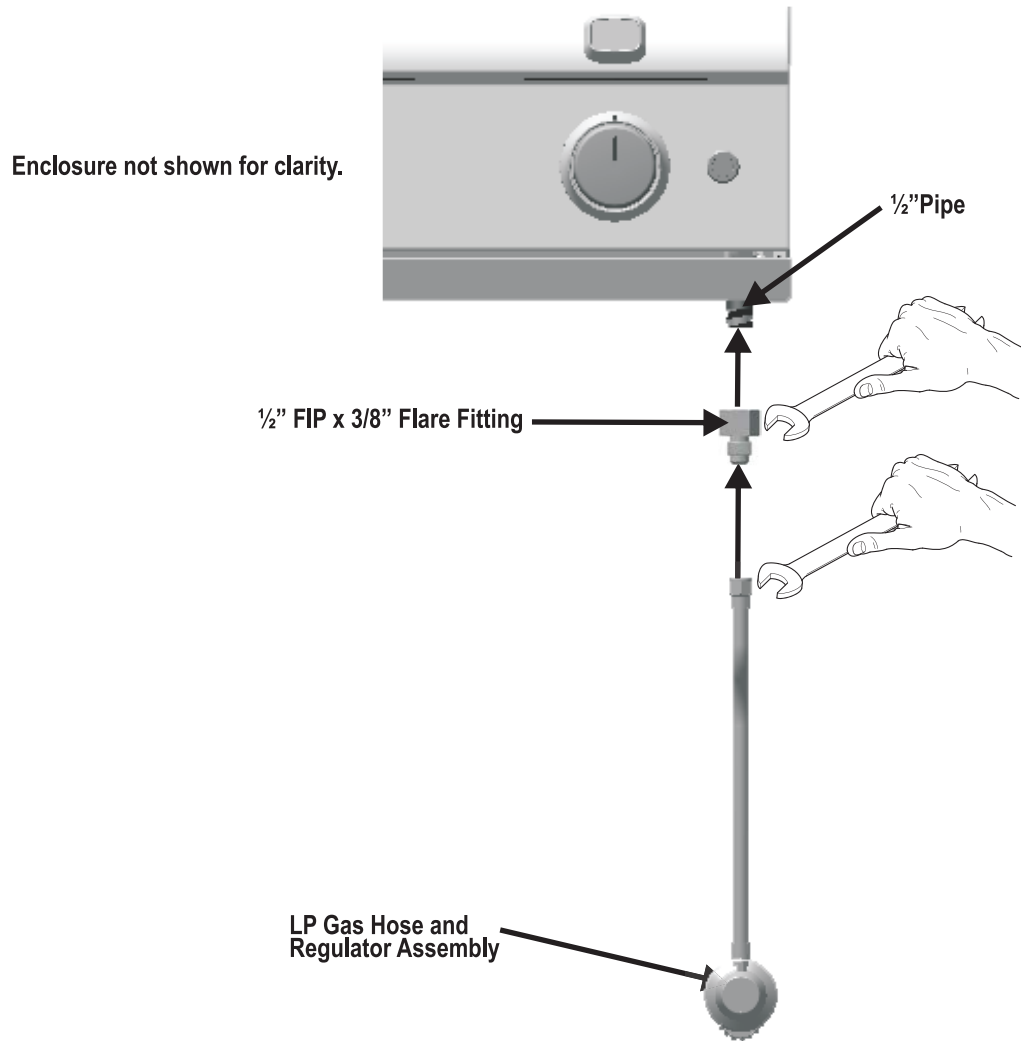

LP CYLINDER INSTALLATION

Step 9

When converting to LP gas, the LP cylinder must be secured in place.

Before mounting the LP cylinder retention bracket, place the LP cylinder inside the grill enclosure and ensure that the LP hose and regulator reaches the LP cylinder for easy attachment. The LP cylinder should rest on its base when attached to the LP hose and regulator.

Attach the LP cylinder retention bracket provided to the inside wall of the grill enclosure with two screws (not provided). See Figures 1 and 2 below for suggested bracket placement

Lift the LP cylinder and place over the retention bracket.

Reference Figure 3 below for the correct opening to use in the LP cylinder collar when installing your LP cylinder.

NOTE: The correct opening MUST be used to correctly secure the LP cylinder to the grill enclosure.

Note: The LP cylinder MUST rest on its base and be supported by the bottom of the grill enclosure and not hang on the retention bracket. The retention bracket is provided only to secure the LP cylinder and prevent it from moving or tipping inside the enclosure.

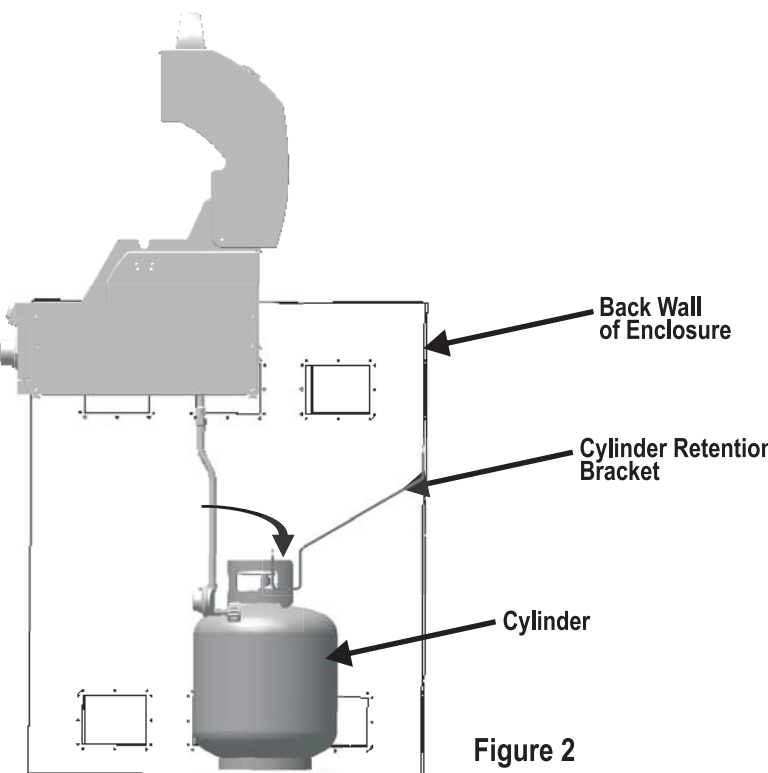
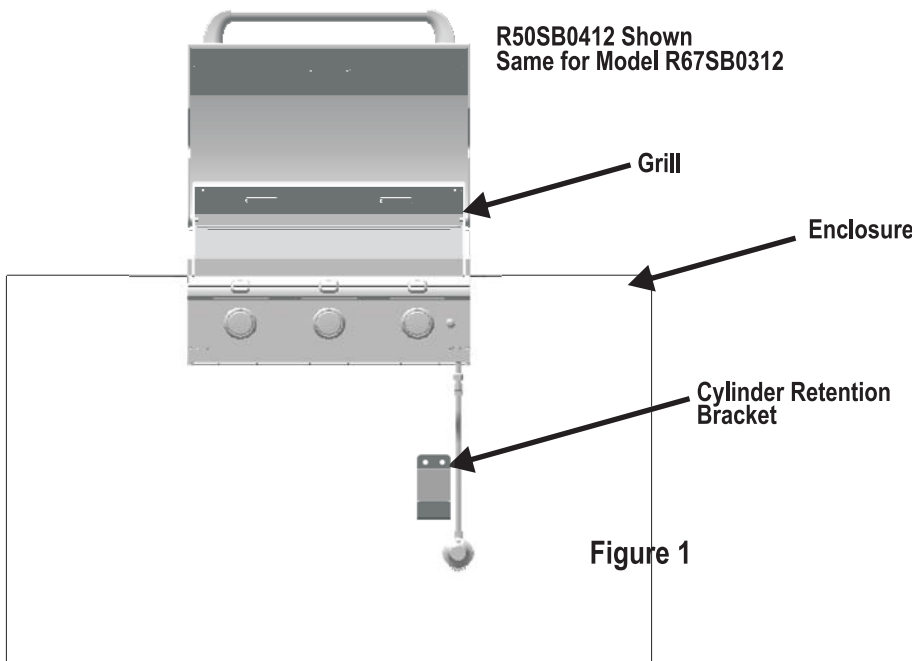

If your cylinder looks like this.

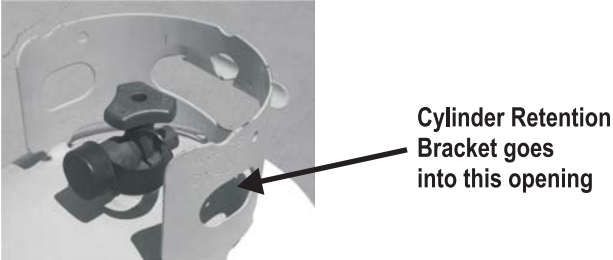
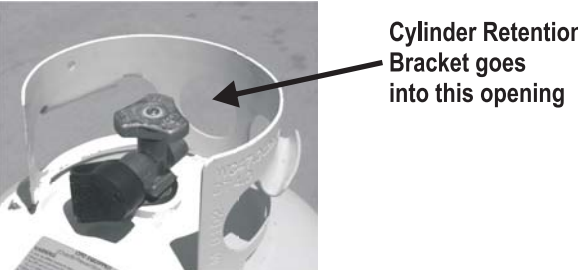

Figure 3

If your cylinder looks like this.



LP CYLINDER INSTALLATION

Step 10

Connecting Regulator to the LP Cylinder

1. Turn all control knobs to the OFF position.
2. Turn LP cylinder OFF by turning hand wheel clockwise to a Full Stop.
3. Remove the protective cap from LP cylinder valve. Always use cap and strap supplied with valve.

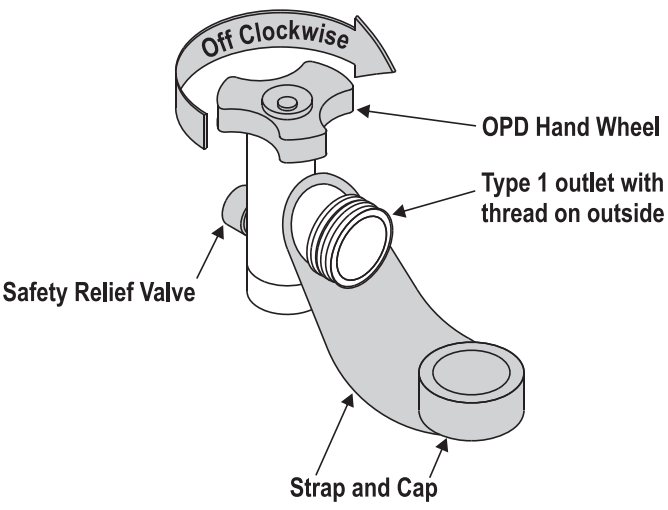

5. Hold regulator and insert nipple into LP cylinder valve. Hand-tighten the coupling nut, holding regulator in a straight line with LP cylinder valve so as not to cross-thread the connection.

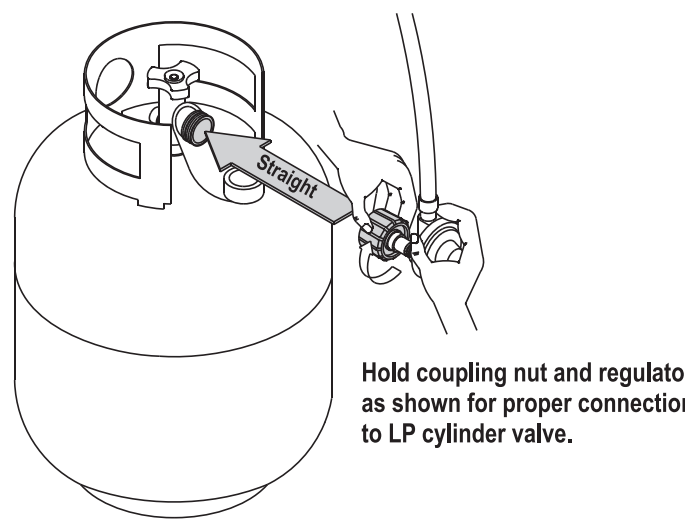
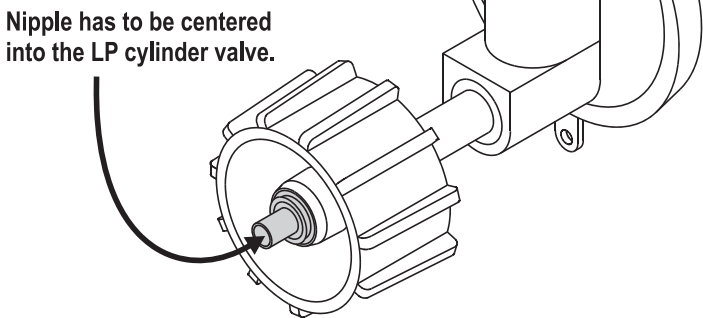

Connecting Regulator to the LP Cylinder (Con't.)

6. Turn the coupling nut clockwise and tighten to a Full Stop. The regulator will seal on the back-check feature in the LP cylinder valve, resulting in some resistance. An additional one-half to three-quarters turn is required to complete the connection. Tighten by hand only - do not use tools.

NOTE:

If you cannot complete the connection, disconnect regulator and repeat steps 5 and 6. If you are still unable to complete the connection, do not use this regulator!



LEAK TESTING

Step 11

Leak Testing Hoses and Regulator

1. Turn all control knobs to the OFF position.
2. Be sure regulator is tightly connected to LP cylinder.
3. Completely open LP cylinder valve by turning hand wheel counterclockwise. If you hear a rushing sound, turn gas off immediately. There is a major leak at the connection. Correct before proceeding.
4. Brush soapy solution onto areas circled below, or other similar fittings on your grill.

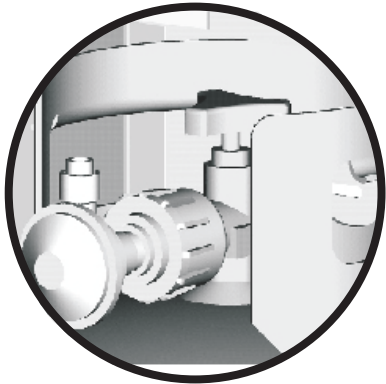

5. If "growing" bubbles appear there is a leak. Close LP cylinder valve immediately and retighten connections. If leaks cannot be stopped do not try to repair. Call for replacement parts.
6. Always close LP cylinder valve after performing leak test by turning hand wheel clockwise.